



KÖSTER KB-Flex 200

Technical Data Sheet J 250

Issued: 2021-08-30

Application-technological testing for sealing annular gaps KÖSTER KB-Flex 200; MFPA Leipzig

Permanently plastic, damp and waterproof sealing compound for waterproofing against pressurized water

Features

Permanently plastic sealing compound for sealing pipe and cable penetrations, cavities, and for custom detail waterproofing solutions against moisture and pressurized water. It does not dry out and remains permanently mouldable. It adheres very well to dry and moist substrates.

Advantages

- Excellent adhesion to multiple substrates
- Easy application from cartridges or with the hand
- Moldable material allows easy replacement of pipes or cables
- Horizontal and vertical (overhead) applications are possible
- Irregular shapes can be sealed
- Good chemical resistance
- Resist water pressure

Technical Data

Material basis	Polyolefin
Color	grey
Specific gravity	1.60 g/cm ³
Heat resistance	max. + 50 °C
Consistency	pasty, non-saggin
Ideal application temperature	+ 30 °C
Application temperature	+ 5 °C to + 35 °C
Substrate temperature	+ 5 °C to + 30 °C

Fields of Application

For sealing pipe and cable penetrations as well as for custom detailed solutions in below ground structures in residential and commercial buildings, as well as engineering structures such as bridges or tunnels and infrastructure systems. Applicable for sealing leaks also in the case of active pressurized water.

- Sealing inside pipes and cable penetrations
- Sealing voids between the structure and pipe penetrations

Substrate

The substrate can be dry, moist or wet. The substrate must be free of grease, tar and oil as well as free of loose particles. Suitable substrates are: concrete, masonry, mortar, plaster and all other mineral construction materials. KÖSTER KB-Flex 200 will also bond to ceramic, PVC, polyethylene, polypropylene, metal and steel.

Application

If applying in cooler temperatures, warm the KÖSTER KB-Flex 200 prior to application by placing in warm water. This ensures that the material has the optimal consistency for application. The application area flanks must be thoroughly cleaned from the inside so that they are free of dust, sand and other loose particles.

Waterproofing made of KÖSTER KB-Flex 200 must be dimensioned so that the ratio of the depth (d) to the width (w) of the installed material is

not below 1.5 : 1. The minimum depth should not be below 8 cm. The maximum diameter of the waterproofing is 300 mm. When applying in larger pipe diameters, additional measures may be required. Please contact the KÖSTER Technical Support for consultation.

Before applying KÖSTER KB-Flex 200, a backing is installed in the penetration at a depth corresponding to the installation depth using a common 2C PU foam. The KÖSTER KB-Flex 200 cartridge is then placed in the gun and the material is pressed into the penetration from back to front.

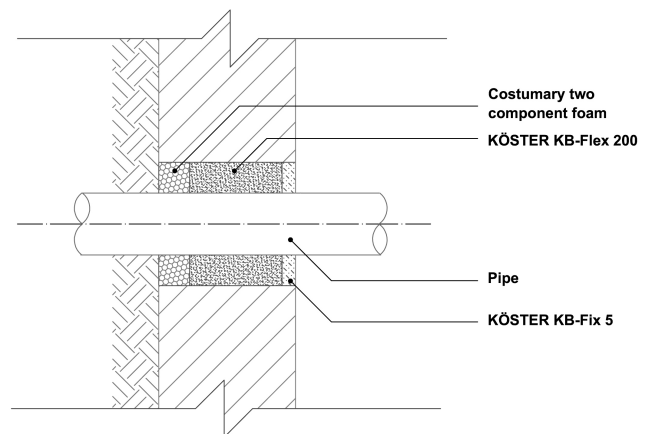

When sealing cable penetrations, jiggle the cables to reveal voids and re-press KÖSTER KB-Flex 200 into any eventual voids created. Ensure that the cable is tension free after finishing the sealing. Finally the sealing compound is recessed 1 - 5 cm (depending on cable thickness and weight) from the wall surface and smoothed with a metal spatula. As an additional safeguard and to hold the pipe / cable centered, the exposed material is covered with KÖSTER KB-Fix 5.

If a new cable is to be installed in this penetration later on, the KB-Fix 5 plug is first removed first and the (new) cable is pushed through the (existing) KÖSTER KB-Flex 200. Finally, if necessary, the penetration is resealed by pressing additional KÖSTER KB-Flex 200 around the cables.

Consumption

Approx. 1.6 kg / l void.

Cleaning

Clean tools and any residues with a cloth or paper towels, oily residue can be removed with KÖSTER Universal Cleaner.

The information contained in this technical data sheet is based on the results of our research and on our practical experience in the field. All given test data are average values which have been obtained under defined conditions. The proper and thereby effective and successful application of our products is not subject to our control. The installer is responsible for the correct application under consideration of the specific conditions of the construction site and for the final results of the construction process. This may require adjustments to the recommendations given here for standard cases. Specifications made by our employees or representatives which exceed the specifications contained in this technical guideline require written confirmation. The valid standards for testing and installation, technical guidelines, and acknowledged rules of technology have to be adhered to at all times. The warranty can and is therefore only applied to the quality of our products within the scope of our terms and conditions, not however, for their effective and successful application. This guideline has been technically revised; all previous versions are invalid.

J - Joint sealing

KÖSTER

Waterproofing Systems

Packaging

J 250 310	310 ml / 500 g cartridge
J 250 530	530 ml / 850 g cartridge

Storage

Store the material in a dry environment at temperature below + 30 °C.
In originally sealed packages it can be stored for a minimum of 24 months.

Other

KÖSTER KB-Flex can be delivered in alternative packaging sizes upon request, such as:

J 250 002 2 kg bucket

J 250 010 10 kg bucket

- Prewarm the material in water for an easier installation.
- Do not apply the material on installations subject to constant high temperatures above 50 ° C.
- Protect the material from mechanical abuse with KÖSTER KB-Fix 5.
- To enhanced adhesion to the pipes, roughen the surface with sand paper.
- If large amounts of material need to be installed due to large pipe diameter or size of the opening, contact the KÖSTER Technical Support for consultation on application techniques.

Related products

KÖSTER KB-Fix 5	Prod. code C 515 015
KÖSTER Special Caulking Gun	Prod. code J 981
KÖSTER KD System	Prod. code W 219
KÖSTER Universal Cleaner	Prod. code X 910 010
KÖSTER Spatula	Prod. code X 987 001

The information contained in this technical data sheet is based on the results of our research and on our practical experience in the field. All given test data are average values which have been obtained under defined conditions. The proper and thereby effective and successful application of our products is not subject to our control. The installer is responsible for the correct application under consideration of the specific conditions of the construction site and for the final results of the construction process. This may require adjustments to the recommendations given here for standard cases. Specifications made by our employees or representatives which exceed the specifications contained in this technical guideline require written confirmation. The valid standards for testing and installation, technical guidelines, and acknowledged rules of technology have to be adhered to at all times. The warranty can and is therefore only applied to the quality of our products within the scope of our terms and conditions, not however, for their effective and successful application. This guideline has been technically revised; all previous versions are invalid.

KÖSTER BAUCHEMIE AG • Dieselstraße 1-10 • D-26607 Aurich • Tel. 04941/9709-0 • Fax -40 • info@koester.eu • www.koester.eu